

# **Bariera bezprzeładkowa SP-04 na słupku Ceowym**

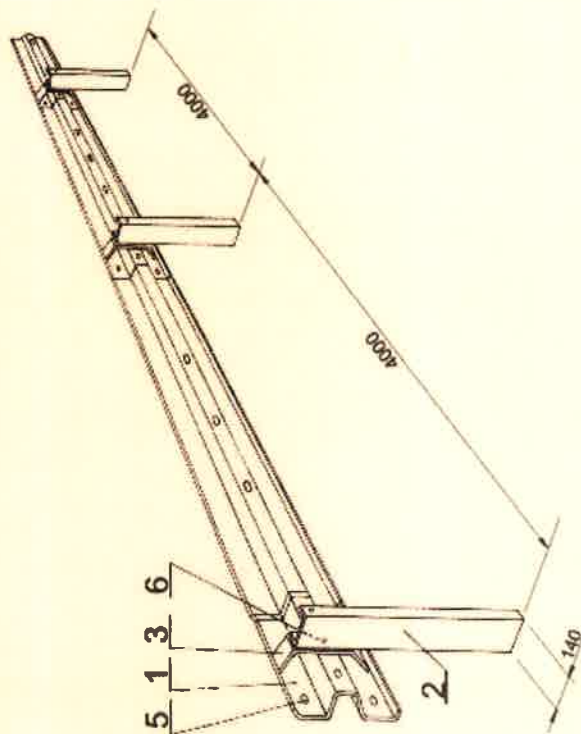
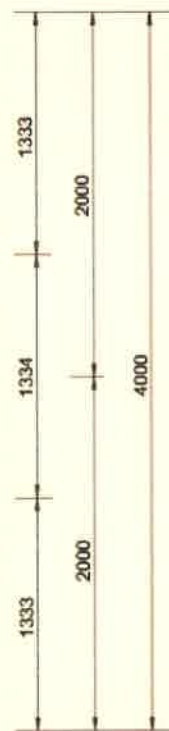
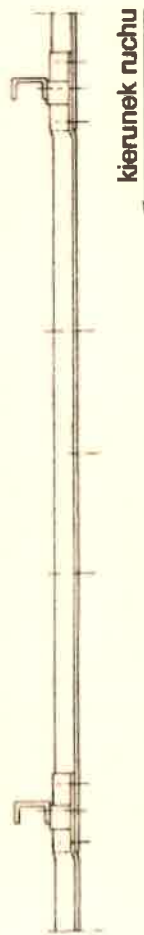
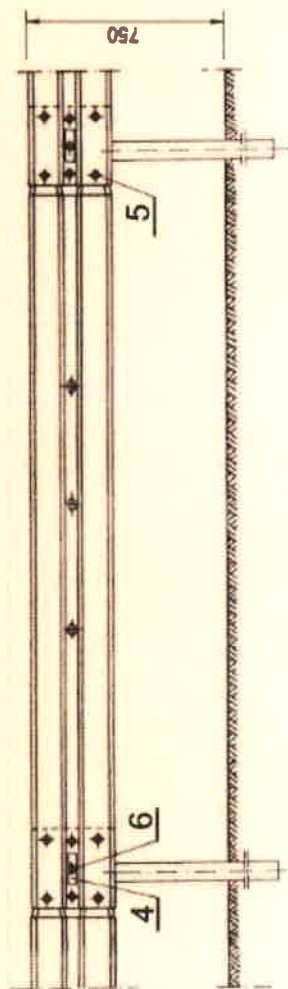

## **OZNACZENIA:**

1. Prowadnica typu B
2. Słupek drogowy C-140
3. Wspornik prowadnicy B
4. Nakładka stykowa M16
5. Śruba noskowa M16x25
6. Śruba noskowa M16x40

## **ODMIANY BARIERY:**

- SP-04/4 - słupki co 4,0 m - (rys.)  
 SP-04/2 - słupki co 2,0 m  
 SP-04/1,33 - słupki co 1,33 m  
 SP-04/1 - słupki co 1,0 m

lewy

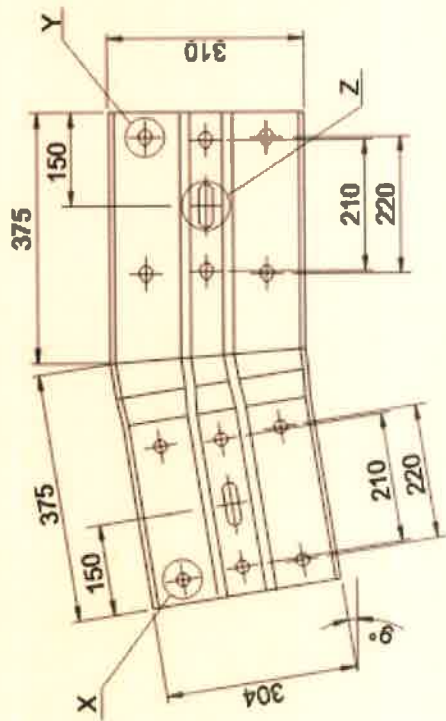

↗ kierunek ruchu

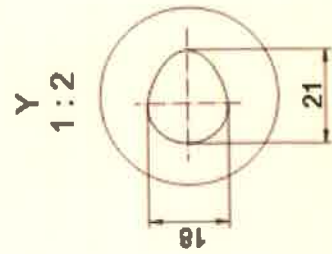
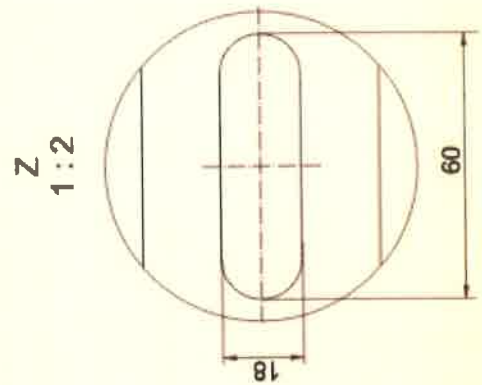
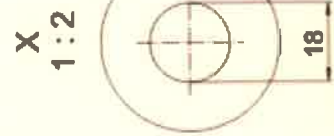

prawy

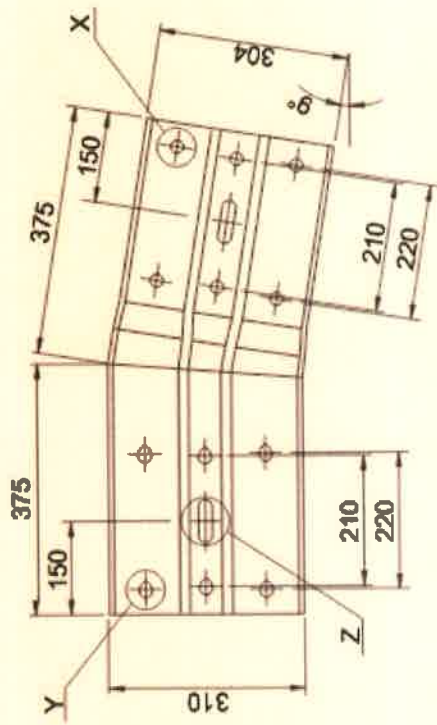

↖ kierunek ruchu

### końcowy (OKR.)

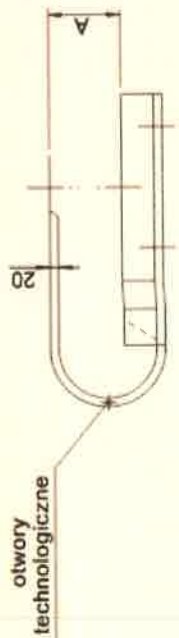
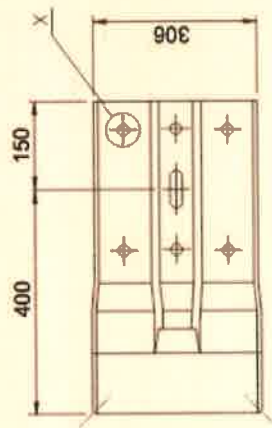

↪ kierunek ruchu

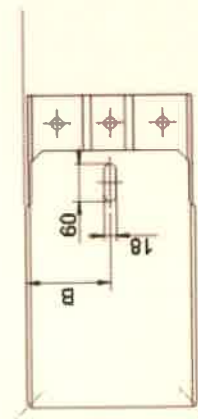

### początkowy (USK.)

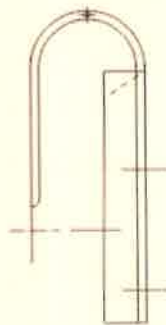
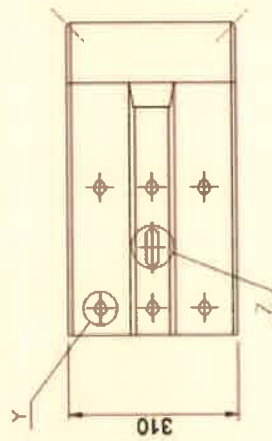

↪ kierunek ruchu

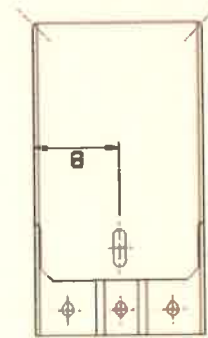

X  
1:2

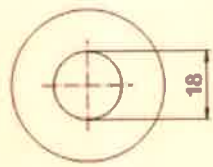

Y  
1:2

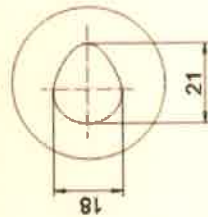

Z  
1:2

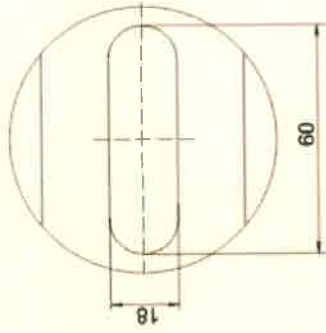

wymiar typ łącznika	A [mm]	B [mm]	Montaż na słupku
100	100	155	Sigma lub IPE-100 bez przekładki
140	140	123	C-140 lub IPE-140 bez przekładki

*[Handwritten signature]*

# Słupek drogowy C140 C140 Road post

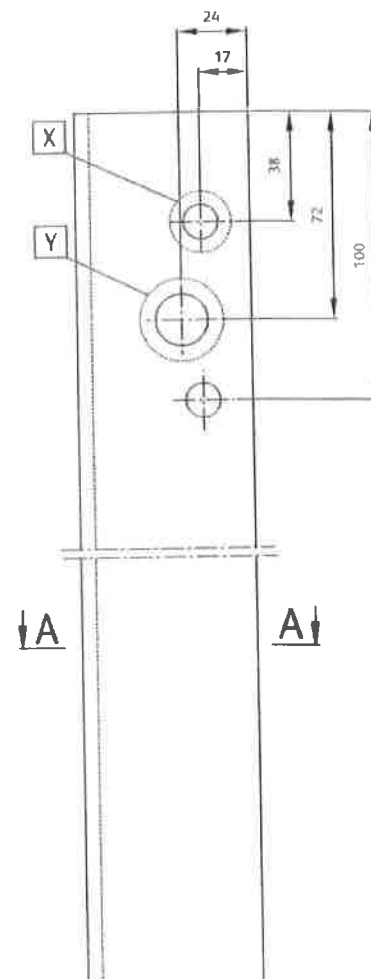
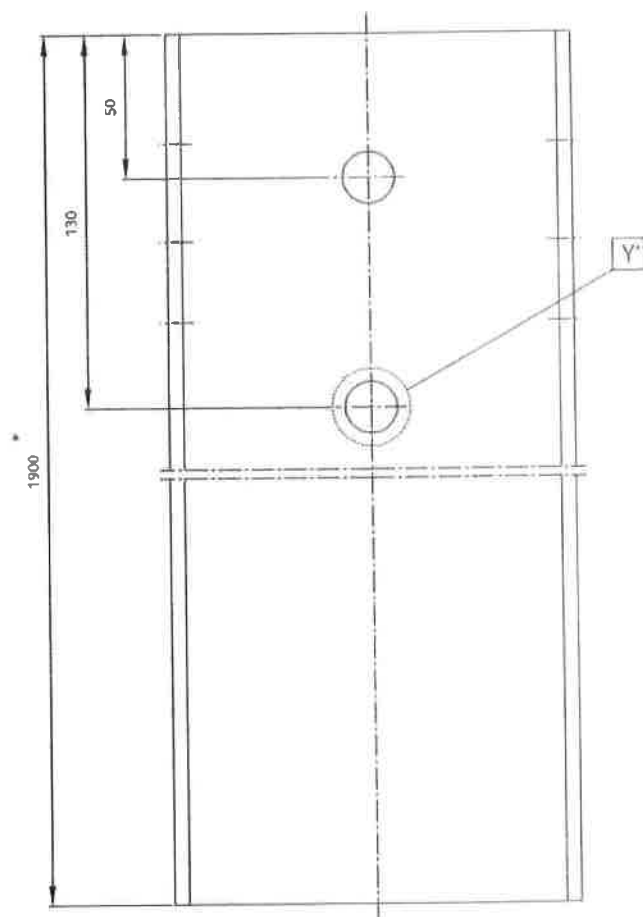

szczegół Y  
detail Y

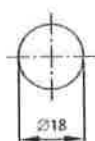

szczegół X  
detail X

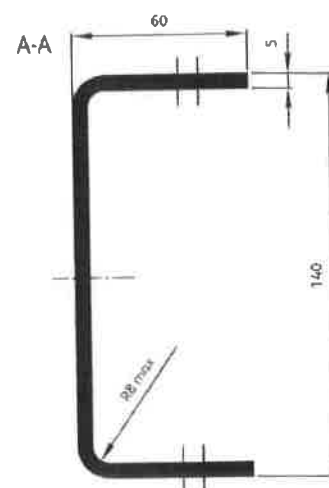
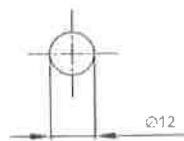

\* Długości mogą być inne na podstawie uzgodnienia przy zamówieniu  
\* different lengths possible if negotiated at order stage